

How to Set up your Marmot Lair 8P Tent

1

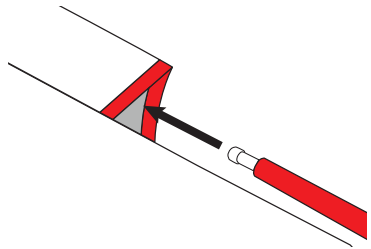
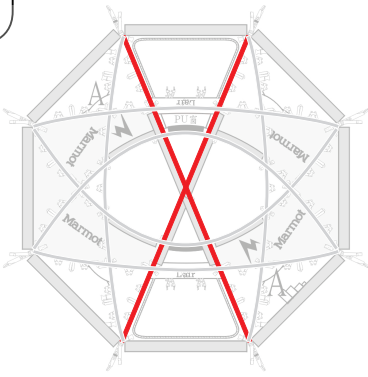

LAY TENT OUT ON FLAT SURFACE. CONNECT **BLACK** POLES AND INSERT **POLES** INTO POLE SLEEVES WITH THE MATCHING **BLACK** TRIM

2

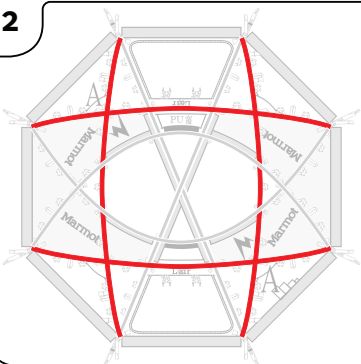

INSERT THE **RED** POLES INTO POLE SLEEVES WITH **RED** TRIM

3

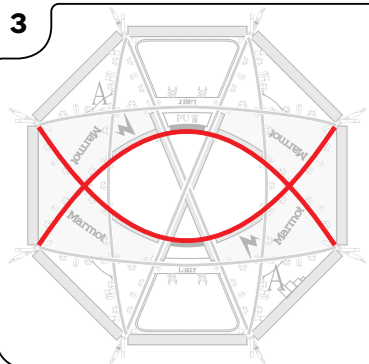

INSERT THE **GOLD** POLES INTO POLE SLEEVES WITH **GOLD** TRIM

4

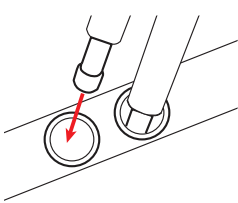

INSERT POLE TIPS INTO GROMMETS

5

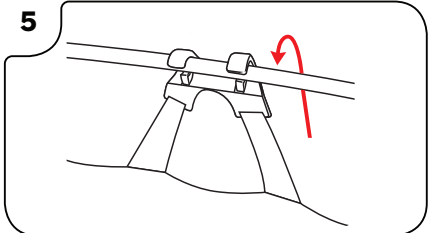

CONNECT CLIPS TO POLES

6 STAKE OUT ALL CORNERS OF TENT AND ATTACH FLOOR TO INTERIOR OF TENT

7

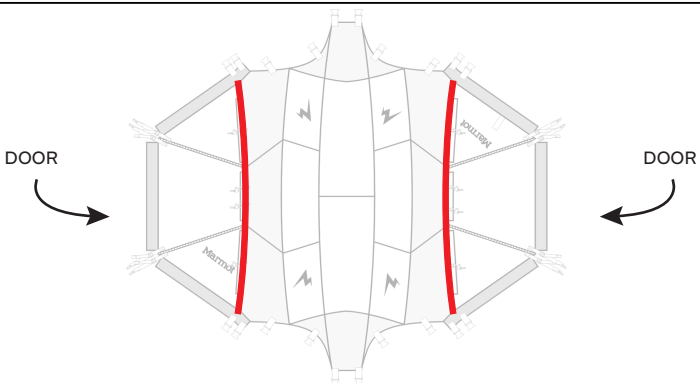

PLACE FLY ON TOP OF TENT ALIGNING DOORS OF TENT AND FLY. CONNECT THEN INSERT THE SHORTER **GOLD** POLES INTO VESTIBULE POLE SLEEVES.

8 GUY OUT USING WEBBING LOOPS ON THE FLY WHEN IN WINDY CONDITIONS

For additional information about your Marmot® tent please visit www.marmot.com