

How to set up your Marmot AGATE tent

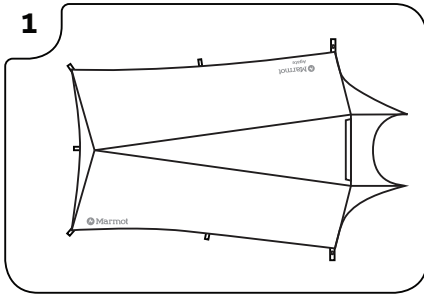

LAY FLY OUT FLAT ON THE GROUND WITH SILVER MARMOT LOGOS FACING UP

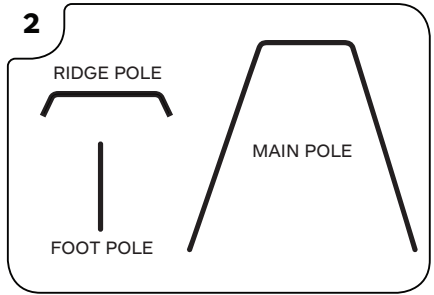

LAY POLES OUT - CONNECT MAIN POLE SEGMENTS IF PLANNING TO USE MAIN POLE

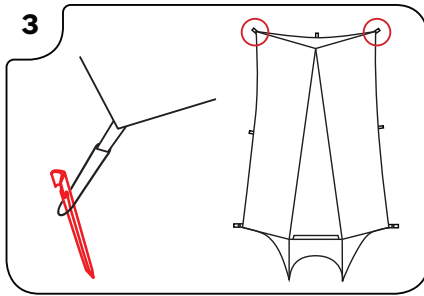

STAKE OUT BACK CORNERS

OPTION A: USING MAIN POLE

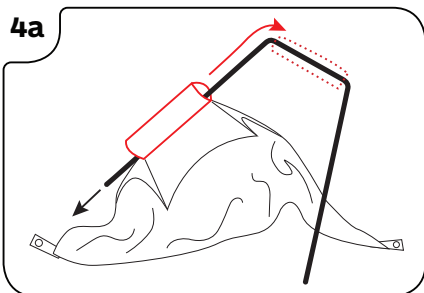

FEED MAIN POLE THROUGH POLE SLEEVE

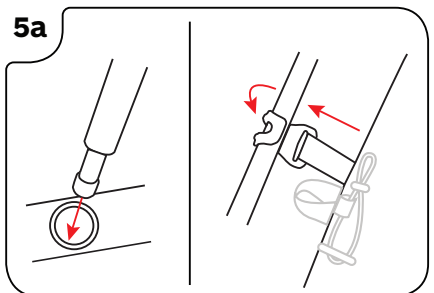

INSERT POLE TIPS INTO GROMMETS - CLIP POLE CLIPS TO EACH SIDE OF THE MAIN POLE

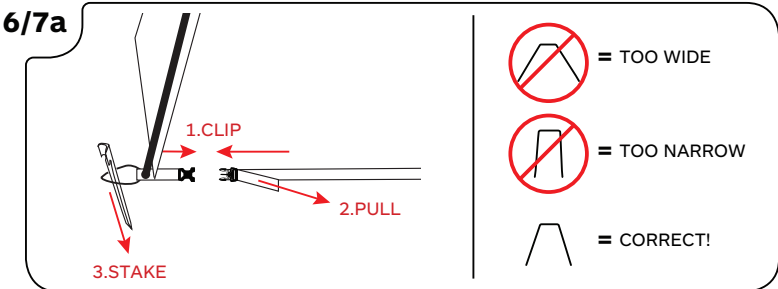

CLIP BUCKLE AND TIGHTEN STRAP TO PULL MAIN POLE INTO CORRECT SHAPE - THEN STAKE OUT FRONT CORNERS

CONTINUED ON NEXT PAGE...



For additional information about your Marmot® tent please visit www.marmot.com

OPTION B: USING RIDGE POLE & TREKKING POLES

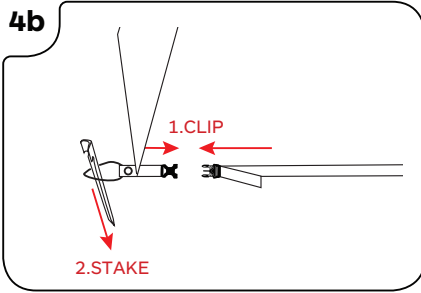

CLIP BUCKLE AND LOOSELY STAKE OUT FRONT CORNERS TO HOLD TENT IN PLACE

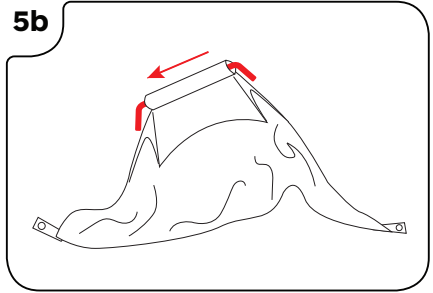

FEED RIDGE POLE THROUGH POLE SLEEVE

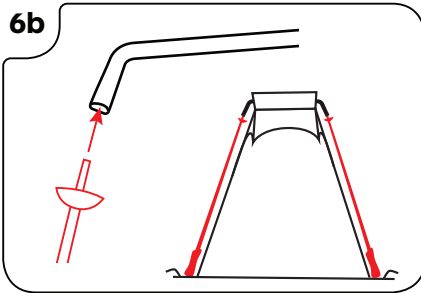

INSERT TIPS OF TREKKING POLES INTO THE RIDGE POLE TO CREATE A MAIN POLE

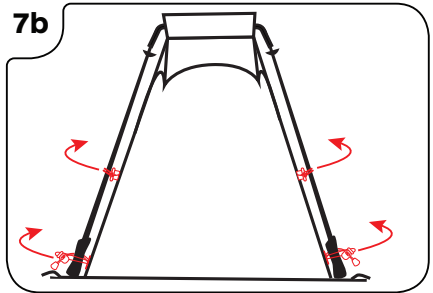

WRAP ELASTIC TIES AROUND TREKKING POLES AND HANDLES

OPTION A & B CONTINUED

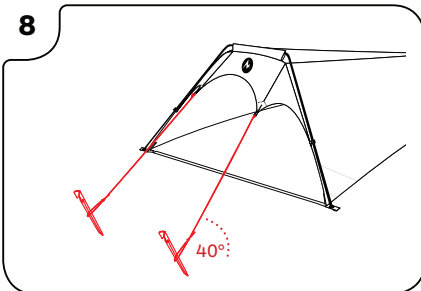

STAKE OUT FRONT GUY OUTS - A 40° ANGLE IS RECOMMENDED FOR BEST TENSION

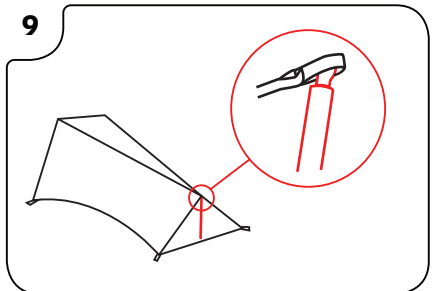

CLIP FOOT POLE INTO PLACE AND STAND IT VERTICALLY TO PROP UP FOOT OF TENT

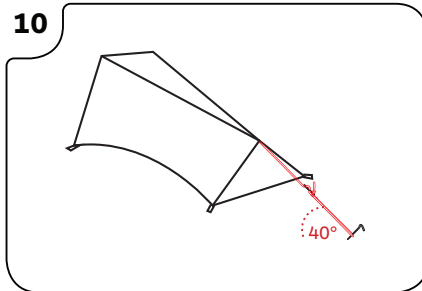

GUY OUT FOOT OF TENT - A 40° ANGLE IS RECOMMENDED FOR BEST TENSION

11 FINE-TUNE STAKE PLACEMENT AND TENSION POINTS AS NEEDED

ADDITIONAL USEFUL TENT INFORMATION

- The Agate ridge pole has an inner diameter of 14mm to accommodate most trekking poles. The optional Main Pole set-up is available as an alternative option.
- All Marmot Tents come with a **Pole Repair Splint**. The hollow, 4-5" Pole Repair Splint can temporarily repair a broken tent pole. Place the splint over the broken pole section. If you believe the broken pole is a warranty issue, please contact Marmot's Warranty Department.
- An optional **Footprint** helps protect you and your tent from twigs, rocks and other debris found on the ground. The footprint is placed under the tent body and is staked out with the body at the stake out points. When using a footprint, place it under the tent body with the coated side facing up.
- Take into consideration the direction of the wind before you pitch your tent. Set up your tent so that the narrowest side of the tent faces the wind.
- In high-wind conditions utilize the **Guy-Line Tabs and Cord** to further anchor the tent. Attach the cord to the guy-line tabs making sure the guy-lines are taut and secured to a tent stake or other object that will hold in high-wind conditions.
- For the most secure set-up, insert the tent stakes into the ground at a 45° angle with the tip/bottom of the stake pointing toward the tent.
- Extended **Exposure to Sunlight** can damage your tent. If possible, avoid leaving your tent pitched in direct sunlight for an extended period of time.
- Never pitch your tent near a **Heat Source or Campfire**. Take into consideration the direction of the wind, and pitch your tent upwind from a campfire to avoid dangerous embers. Do not use an open flame in or around your tent. **Do Not Cook or Use a Heat Source** in the tent or vestibule.
- Always **Clean and Dry** your tent before storage. A wet, dirty or damp tent can lead to mildew damage.

CLEANING, CARE and STORAGE

If necessary, use a **sponge and warm water** to clean your tent. If the entire tent requires cleaning, wash by hand in cold water, but do not soak the tent for an extended period of time. Do not use hot water, bleach, dish-washing soap or detergent to wash the tent. If needed, a mild, non-detergent based soap can be used to clean the tent.

Do not use a washing machine or dryer to clean the tent as it could damage the waterproof coating. To dry the tent, either pitch it in the shade, or hang it on a line to dry. Be sure the tent is completely dry before storing it.

Always store your tent in a **cool dry place**. Keeping your tent in a hot car, for example, can damage the tent.



For additional information about your Marmot® tent
please visit www.marmot.com